

# INFRARED DETECTOR USER'S GUIDE



## UNIVERSAL INFRARED DETECTOR FOR AUTOMATIC

### TECHNICAL SPECIFICATIONS

Technology	: Infrared
<b>RECEIVER</b>	
RANGE	: ≤20m : Range can be reduced 30% in bad weather conditions: for rain, dust, etc.
Infra-Red Frequency	: 2.4 KHz
POWER SUPPLY	: 12 to 24V DC
WAVE LENGTH	: 910nm
INPUT	: RX 15mA - TX 30mA
OPERATING TEMPERATURE	: -10°C to 55°C
RELAY OUTPUT	: 1A max 36V
DIMENSIONS	: 48.2 x 76 x 30.1mm

### CONNECTING THE DETECTOR

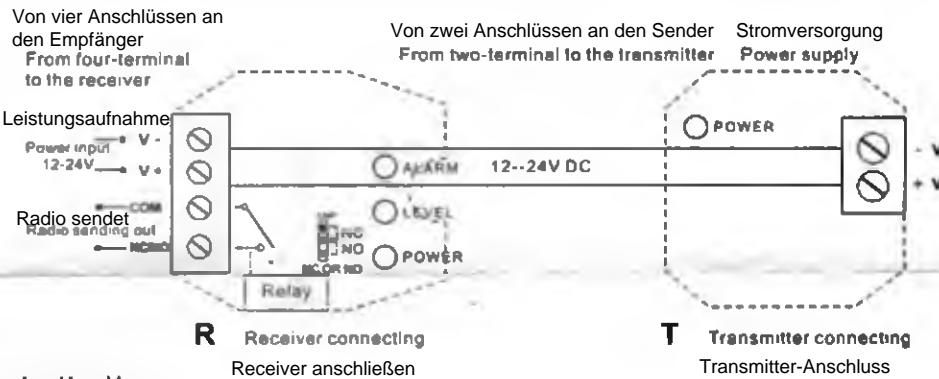

### Installation

The best install height should be more than 20cm, and the install distance should be not less than 2m. Infrared protection device should be placed vertically and in a same horizontal line when installation.

Die beste in der Stallhöhe sollte mehr als 20 cm sein, und tho Abstand installieren sollte als 2 m nicht unterschritten werden. Infrarot-Schutzvorrichtung sollte vertikal und in einer gleichen horizontalen Linie, wenn in Installation platziert werden.

**Note:**

Because the product's transmission power is larger, it will happen no reaction phenomenon when the transmitter is too close to the receiver. Try again when making their distance at least 1 meter. You find insensitive phenomenon when the installation distance is very close, then remove the collector lens which is transmitting and receiving. It can improve sensitivity.

Hinweis: Da die Sendeleistung des Produkts größer ist, wird es keine Reaktion Phänomen passieren, wenn zu nahe der Sender zum Empfänger ist, erneut versuchen, wenn ihr Abstand mindestens 1 Meter zu machen.

### MOUNTING THE DETECTOR

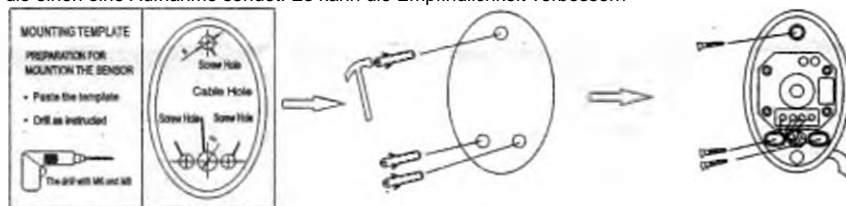

Note don't install oppositely, otherwise into water. Hinweis installieren Sie nicht entgegengesetzt, ansonsten in Wasser

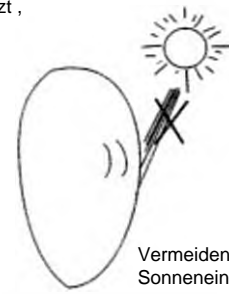

Vermeiden Sie direkte Sonneneinstrahlung  
Avoid direct sunlight